

Einspeiseblock für Motorschutzschalter, Gabel

Artikel-Nr. Art.-no N° article	Farbe Colour Couleur	GTIN-Code 4046931...	(Anschluss) Querschnitt (Connecting)Cross section Coupe transversale	Phasen Phase Phase	VPE Pack. Emballage	Cu/CuZn Zahl Cu/CuZn Code Cu/CuZn Codé
		[GTIN-13]	[Cu / mm <sup>2</sup> ]	[1...4]	[Unit]	[kg]
01.116.100		023929	3 x 25	3	10	0,025

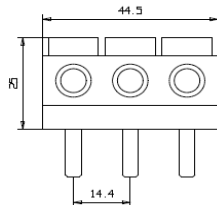
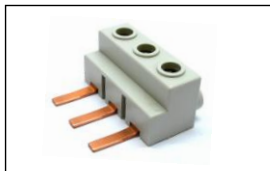

Einspeiseblock für Motorschutzschalter, Stift

Artikel-Nr. Art.-no N° article	Farbe Colour Couleur	GTIN-Code 4046931...	(Anschluss) Querschnitt (Connecting)Cross section Coupe transversale	Phasen Phase Phase	VPE Pack. Emballage	Cu/CuZn Zahl Cu/CuZn Code Cu/CuZn Codé
		[GTIN-13]	[Cu / mm <sup>2</sup> ]	[1...4]	[Unit]	[kg]
02.116.100		023936	3 x 25	3	10	0,025

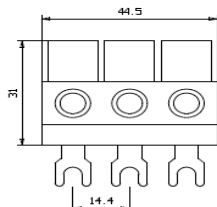
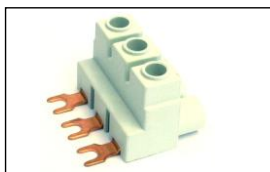

Einspeiseblock für Motorschutzschalter nach UL 508

Artikel-Nr. Art.-no N° article	Farbe Colour Couleur	GTIN-Code 4046931...	(Anschluss) Querschnitt (Connecting)Cross section Coupe transversale	Phasen Phase Phase	VPE Pack. Emballage	Cu/CuZn Zahl Cu/CuZn Code Cu/CuZn Codé
		[GTIN-13]	[Cu / mm <sup>2</sup> ]	[1...4]	[Unit]	[kg]
01.115.100		023943	3 x 25	3	10	0,025

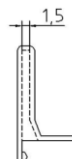
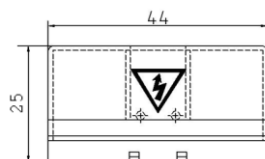
Berührungsschutzkappe  
für Drehstromschienenblöcke

Artikel-Nr. Art.-no N° article	Farbe Colour Couleur	GTIN-Code 4046931...	(Anschluss) Querschnitt (Connecting)Cross section Coupe transversale	Phasen Phase Phase	VPE Pack. Emballage	Cu/CuZn Zahl Cu/CuZn Code Cu/CuZn Codé
		[GTIN-13]	[Cu / mm <sup>2</sup> ]	[1...4]	[Unit]	[kg]
01.001.401		023950	---	3	10	---