

EKDP15

DIGIT VOLTAGE AMPERE METER

ORDERING CODE

DP15 - D/A

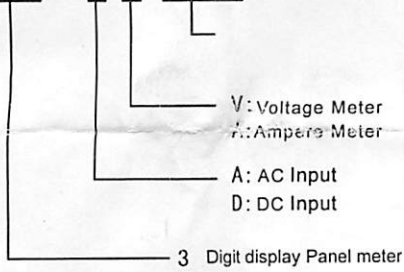

AC DIGIT VOITMETER:

Direct Input: AC 600V, 99.9V, 9.99V,

PT Input: It according to customer's offers

AC DIGIT AMMETER:

CT Input(5A):

5A. 10A, 15A, 20A, 30A. 40A. 50A, 60A. 70A. 80A. 90A. 100A150A, 200A, 300A. 400A. 500A, 600A. 700A. 800A. 900A. 1000A,

DC DIGIT VOITMETER:

Direct Input: DC 600V, 99.9V, 9.99V,

DC DIGIT AMMETER:

CT Input(75mV):

5A. 10A, 15A, 20A, 30A. 40A. 50A, 60A. 70A. 80A. 90A. 100A150A, 200A, 300A. 400A. 500A, 600A. 700A. 800A. 900A. 1000A,

EKDP15-A (A)

	K1	K2	K3	K4
	1	2	4	8
1	↑			
2		↑		
3	↑	↑		
4			↑	
5	↑		↑	
6		↑	↑	
7	↑	↑	↑	
8				↑
9	↑			↑
15	↑	↑	↑	↑

	K5	K6
	10	100
X		
X10	↑	
X100		↑
X1000	↑	↑

EKDP15-V (V)

	K1	K2	K3	K4
600				
100			↑	↑
10	↑	↑		

SPECIFICATION

- Power Supply: AC/DC 100~240V
- Accuracy: 0.5%FS ± 1Digit
- Operating temperature: 0~50°C <85%RH
- Power consumption: ≤4VA
- Weight: 150g
- Display: LED Red
- Input: AC DIGIT VOITMETER 600 (MAX700V)
AC DIGIT AMMETER: 5A

DIMENSISONS

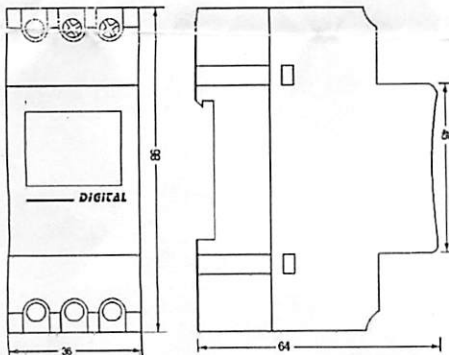

CONNECTIONS

